

Back Tilt Kit

The SolaRack® Back Tilts are designed to be installed to a rail supporting a solar array. Tilt Kits are available in 3 different sizes allowing for easy and flexible installation. Available in 0° - 15°, 15° - 30° and 30° - 45°.

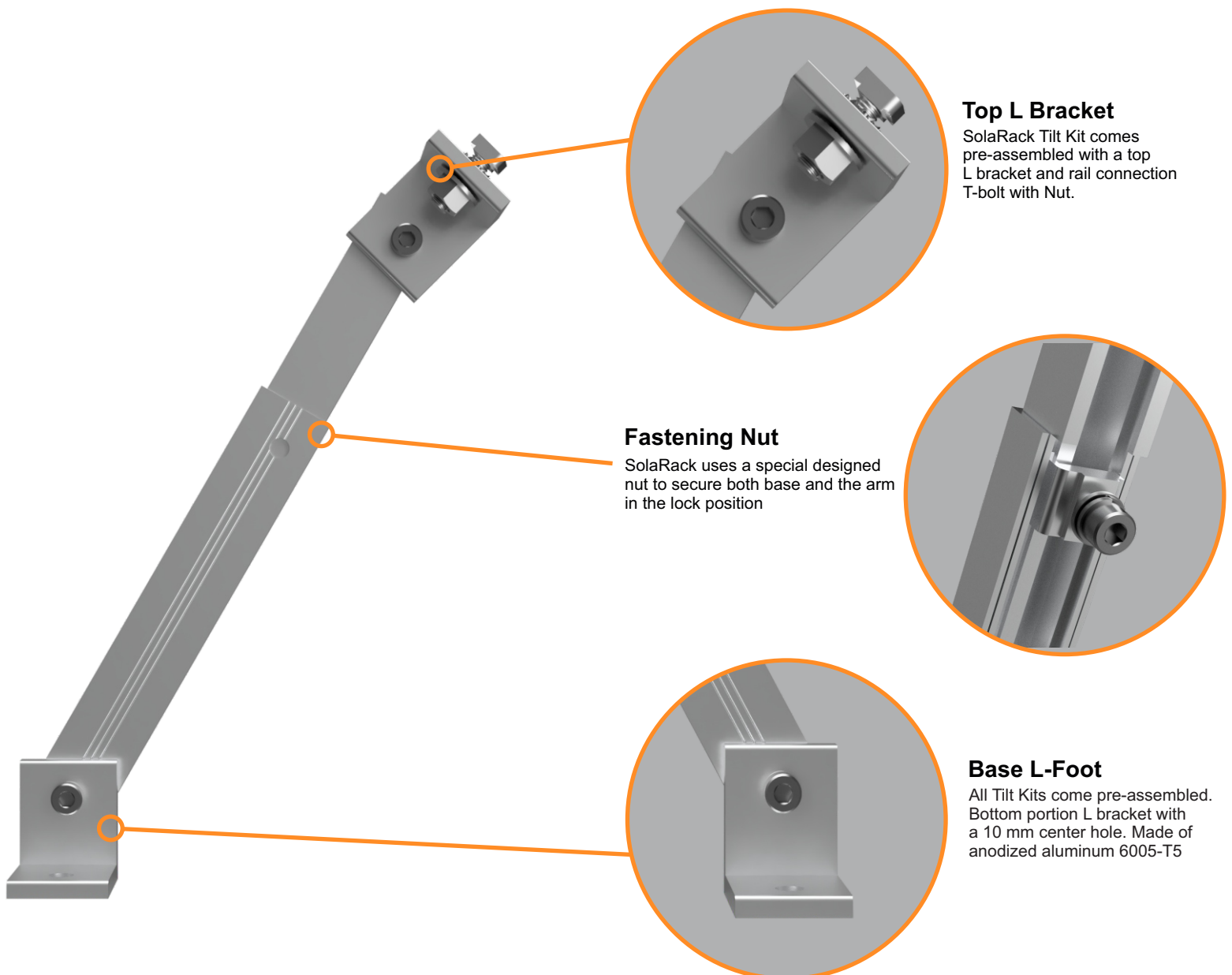

Top L Bracket

SolaRack Tilt Kit comes pre-assembled with a top L bracket and rail connection T-bolt with Nut.

Fastening Nut

SolaRack uses a special designed nut to secure both base and the arm in the lock position

Base L-Foot

All Tilt Kits come pre-assembled. Bottom portion L bracket with a 10 mm center hole. Made of anodized aluminum 6005-T5

SolaRack Inc.

1103 Lawrence Dr. Unit A
Newbury Park CA 91320
W: www.solarackusa.com
E: info@solarackusa.com
P: 1.844.686.rack (7225)

* Not all locations will allow the installation of any type of tilt kits, please check with local jurisdiction prior to installation.